

## Features

- Low Insertion Loss
- High Attenuation
- Compact Size
- Surface Mount

## Descriptions

Surface mount monoblock ceramic bandpass filter.

## Electrical Specifications

Parameter	Unit	Specification
Center Frequency (Fc)	MHz	1030
Passband Frequency Range	MHz	1015 ~ 1045
Insertion Loss @ Fc	dB	3.0 max @ 1030 MHz
		3.2 max @ 1025 ~ 1035 MHz
Ripple in Passband	dB	0.5 max @ 1025 ~ 1035 MHz
V.S.W.R.	-	1.7 max
Attenuation	dB	25 min @ DC ~ 900 MHz
		20 min @ 1090 ~ 1300 MHz
Operating Input Power	Watts	1 max average, 2 max peak
IN/OUT Impedance	Ohm	50
Vibration 10 ~ 500 Hz	g	5 max
Shock for 11 msec	g	15 max
Relative Humidity	%	90 max
Non-Operating Temperature	°C	-30 ~ +85
Operating Temperature	°C	-40 ~ +100
Dimensions	mm	8.40 x 4.00 x 2.00 (L x W x H)
RoHS	-	Yes

## Mechanical Drawing

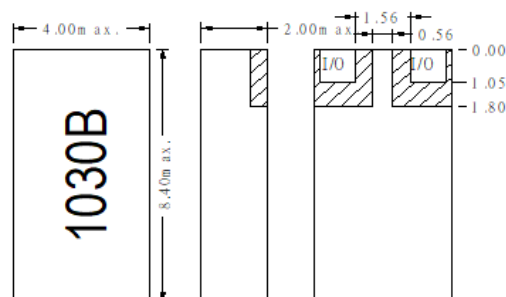

Tolerance :x ± 0.3  
 :xx ± 0.15  
 Unit: mm