



Monolithic Block Filter Specification

Customer Part No: RFM2400850
MFG Part No: BPF0291A
Date: 3/24/2006

Electrical Specifications

<u>Parameter</u>	<u>Frequency MHz</u>	<u>Typical @ 25°C</u>	<u>Specification @ 25°C</u>	<u>Spec over -40°C to +85°C</u>
Passband Iloss	3425 - 3450	-2.1	-2.6	-3.0
Passband Ripple	3425 - 3450	0.2	0.5	0.5
Passband Return Loss @ TX	3425 - 3450	-17.0	-14.0	-14.0
Passband Return Loss @ Ant	3425 - 3450	-17.0	-14.0	-14.0
Attenuation	0.1 - 2475	-50.0	-35.0	-35.0
	2940 - 2971	-44.0	-40.0	-40.0
	3184 - 3211	-39.0	-35.0	-35.0
	3303 - 3330	-33.0	-30.0	-30.0
	3524 - 3551	-15.5	-12.0	-12.0
	3975 - 5000	-51.0	-35.0	-35.0
Power into any port		2 Watt max		

Note: Supplier shall test each filter to the critical electrical specifications of the above table. Any subsequent audits may deviate from in value due to measurement repeatability among different test systems. Such deviations shall not exceed the following limits:

Specification Allowance
 Insertion Loss 0.1 dB
 Return Loss 1.0 dB
 Stopbands 1.0 dB

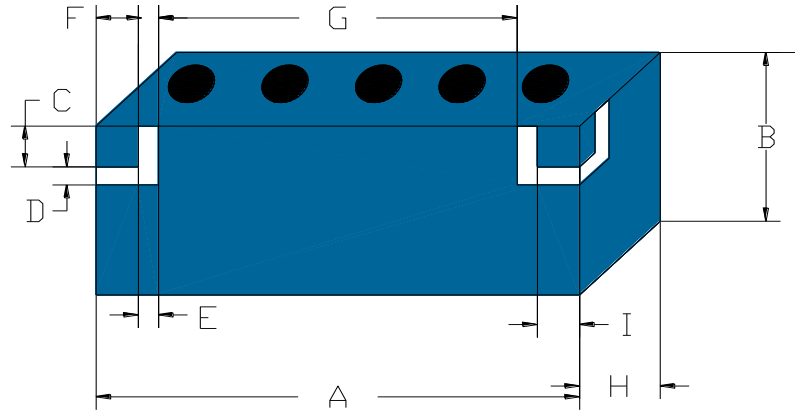

Mechanical Drawing

Dim	Nominal (mm)	Tolerance (mm) +/- or max
A	8.40	Max
B	5.60	Max
C	1.50	0.13
D	0.80	0.13
E	0.90	0.13
F	1.37	0.13
G	3.86	0.13
H	2.80	Max
I	1.37	0.013

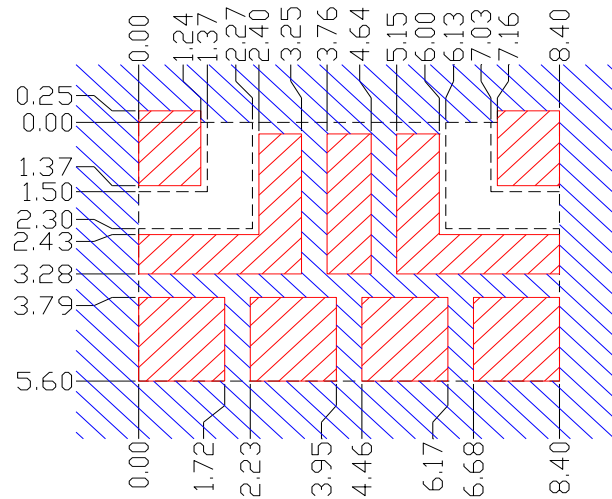

PCB Layout



- Filter Outline
-  Exposed Conductor
-  Solder Resist Over Dielectric
-  Solder Resist Over Conductor



Electrical response

