



## Monolithic Block Filter Specification

**Customer Part No:** RFM2400851  
**MFG Part No:** BPF0292A  
**Date:** 3/24/2006

### Electrical Specifications

<u>Parameter</u>	<u>Frequency MHz</u>	<u>Typical @ 25°C</u>	<u>Specification @ 25°C</u>	<u>Spec over -40°C to +85°C</u>
Passband Iloss	3525 - 3550	-2.2	-2.6	-3.0
Passband Ripple	3525 - 3550	0.2	0.5	0.5
Passband Return Loss @ TX	3525 - 3550	-17.0	-14.0	-14.0
Passband Return Loss @ Ant	3525 - 3550	-17.0	-14.0	-14.0
Attenuation	0.1 - 2475	-50.0	-35.0	-35.0
	3040 - 3071	-44.0	-40.0	-40.0
	3284 - 3311	-39.0	-35.0	-35.0
	3403 - 3430	-36.0	-30.0	-30.0
	3424 - 3451	-25.8	-15.0	-15.0
	3975 - 5000	-51.0	-35.0	-35.0
Power into any port		2 Watt max		

Note: Supplier shall test each filter to the critical electrical specifications of the above table. Any subsequent audits may deviate from in value due to measurement repeatability among different test systems. Such deviations shall not exceed the following limits:

Specification Allowance  
 Insertion Loss      0.1 dB  
 Return Loss         1.0 dB  
 Stopbands            1.0 dB

## Mechanical Drawing

Dim	Nominal (mm)	Tolerance (mm) +/- or max
A	8.40	Max
B	5.60	Max
C	1.50	0.13
D	0.80	0.13
E	0.90	0.13
F	1.37	0.13
G	3.86	0.13
H	2.80	Max
I	1.37	0.013

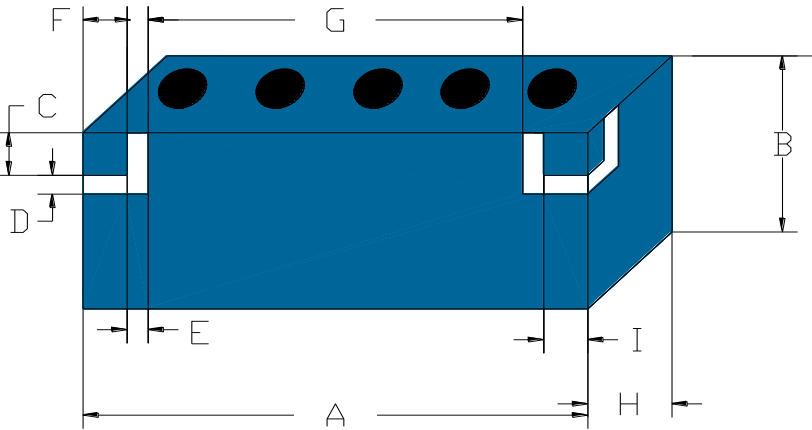

## PCB Layout

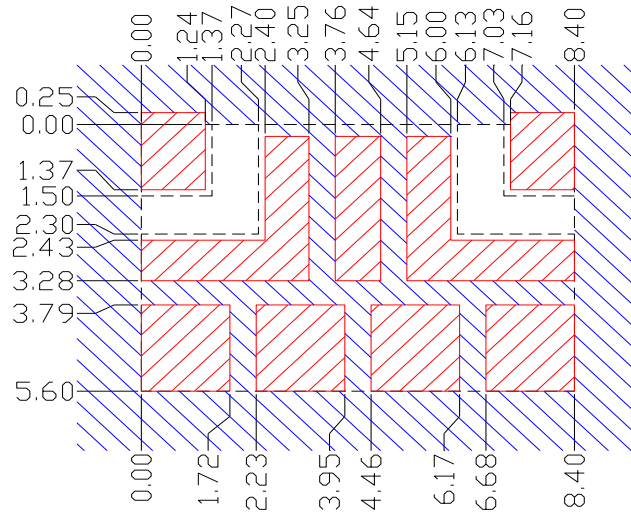

----- Filter Outline

 Exposed Conductor

 Solder Resist Over Dielectric

 Solder Resist Over Conductor



# Electrical response

