

## Dielectric Filter Specification

Part No: **MBP32R9602S04A**

Date:

**Specification:**

No.	Characteristics	Unit	Typical	Minimum	Maximum
1	Frequency Range	MHz	960	958	962
2	Bandwidth	MHz			26
3	Insertion Loss	dB	2.0		3.0
4	Ripple in BW	dB	0.5		0.5
5	V.S.W.R.		1.5		1.5
6	Attenuation	@ 930 MHz		20	
		@ 990 MHz		12	

**Dimensions:**

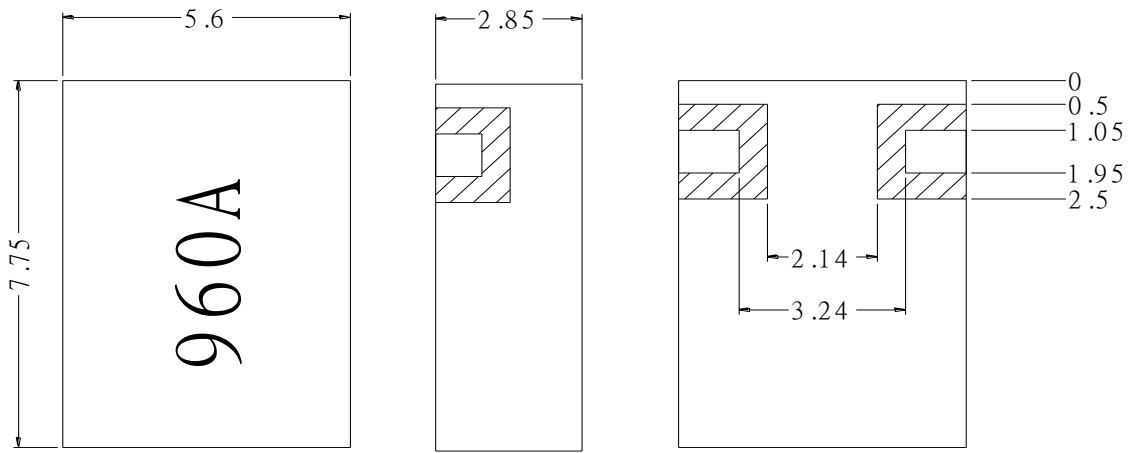

Tolerance Unless  
 Otherwise Specified :  $\pm 0.30$   
 Unit : mm