

Features

- Compact Size
- Optimum Phase Linearity
- RF Pin Surface Mount
- LC Filter

Descriptions

RF pin surface mount LC Filter developed for XXX applications. It is shielded with a metal cover.

Electrical Specifications

Parameter	Unit	Specification
Center Frequency Fc	MHz	510
3 dB Band Width	MHz	8.0 (506~514)
0.5 dB Band Width	MHz	4.0 (508~512)
Insertion Loss @ Fc	dB	9.5 max
Return Loss (VSWR)	dB	1.5:1
Phase Linearity	Radian	1.8 max @ 506 ~ 514MHz
		1.0 max @ 508 ~ 512MHz
Attenuation	dB	10 min @ 495 & 530MHz
		20 min @ 490 & 540MHz
		30 min @ 480 & 550MHz
		40 min @ 470 & 575MHz
		60 min @ 450 & 600MHz
Power Handling	Watt	1 average
IN/OUT Impedance	Ω	50
Operating Temp. Range	$^{\circ}\text{C}$	-55 ~ +85
Humidity	%	95
Dimensions	inch	1.0 L x 0.5 W x 0.4H

Mechanical Drawing

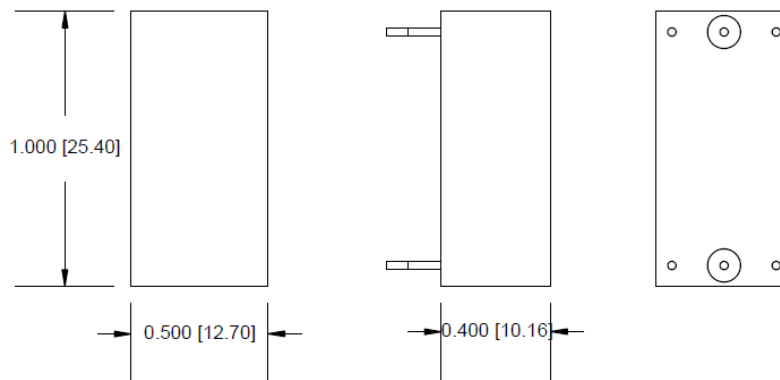

Electrical Response

