

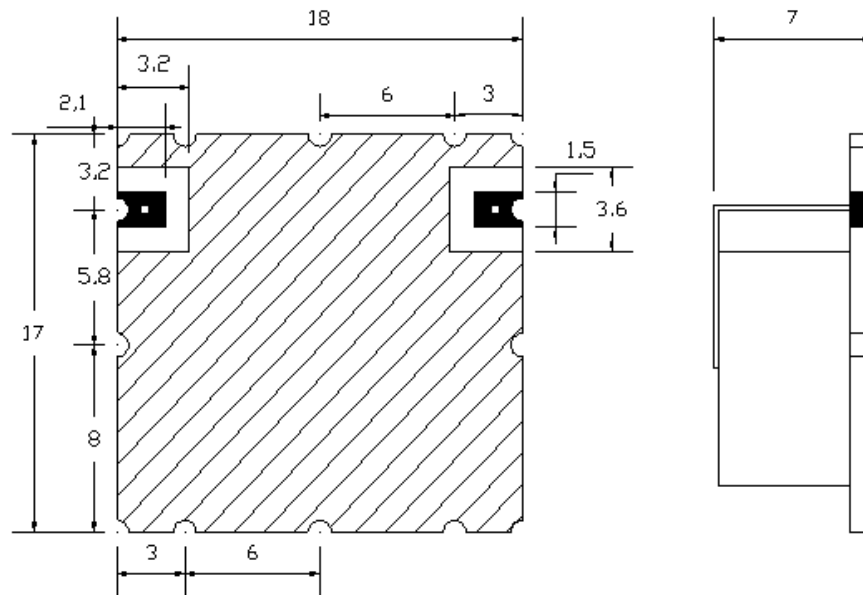



Electrical Specifications

| No. | Parameter | Unit | Specification |
|-----|----------------------|------|----------------------|
| 1 | Center Frequency | MHz | 1030 |
| 2 | Frequency Range | MHz | 1025.5~1034.5 |
| 3 | Insertion Loss in BW | dB | 4.0 max. |
| 4 | Ripple in BW | dB | 2.0 max. |
| 5 | Return Loss in BW | dB | 15 min. |
| 6 | Attenuation | dB | 26 min. @ 1015MHz |
| | | | 25 dB min. @ 1045MHz |
| 7 | Input Power | W | 1W max. |
| 8 | In / Out Impedance | Ohm | 50 |
| 9 | Operating Temp. | °C | -30 ~ +70 |
| 10 | RoHS | - | Yes |

Dimensions (unit: mm)



 : I/O PORT

**TOLERANCE UNLESS
SPECIFIED : +/- 0.2**

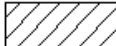
 : GRUND

Unit : mm



Simulation

