



Specifications

Discrete Ceramic Filter

Design	Engineering	Approval
CYK	MHJ	ECL

Customer:	Date: 04-04-12	P/N: BPX2248-516B1
-----------	----------------	--------------------

Electrical Specifications

No.	Parameter	Unit	Specification
1	Center Frequency	MHz	2248
2	Pass Bandwidth	MHz	$F_c \pm 258$ min. (1990 ~ 2506MHz)
3	Insertion Loss at F_c	dB	1.0 max. at Center
4	Ripple in BW	dB	0.5 max.
5	Return Loss in BW	dB	15.0 min.
6	Attenuation	dB	50 min. @ 1448MHz
			30 min. @ 3248MHz
7	Input Power	Watt	3 max.
8	IN/OUT Impedance	Ω	50
9	Operating Temp. Range	$^{\circ}\text{C}$	-40 ~ +85

Dimensions [Unit: mm]

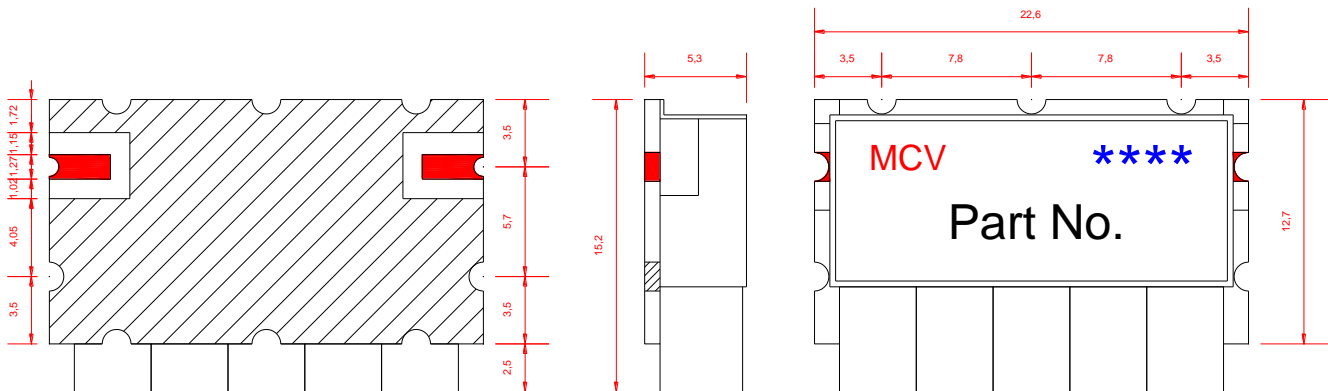

Notes :

1. Surface mount package
2. Dimensions in millimeters
3. Max reflow temperature 240°C for 10 sec
4. If boards are cleaned after installation units must be completely dried
5. Tolerance unless specified : ± 0.3
6. **** -> Date code (YYWW)

- : In / Out Port
- : G round
- : No metal

Simulation Graph

