

## Features

- Compact Size
- Optimum Phase Linearity
- RF Pin Surface Mount
- LC Filter

## Descriptions

RF pin surface mount LC low pass filter developed for VHF applications. It is shielded with a metal cover.

## Electrical Specifications

Parameter	Unit	Specification
Cutoff Frequency Fc	MHz	66
Insertion Loss	dB	1.0 max @ 60 MHz
Return Loss (VSWR)	dB	1.25:1
Phase Linearity	Radian	$\pm 1$ max @ 56 ~ 64MHz
Attenuation	dB	40 min @ 97MHz
IN/OUT Impedance	$\Omega$	50
Operating Temp. Range	$^{\circ}\text{C}$	-25 ~ +85
Humidity	%	95
Dimensions	inch	1.0 L x 0.5 W x 0.4H

## Mechanical Drawing

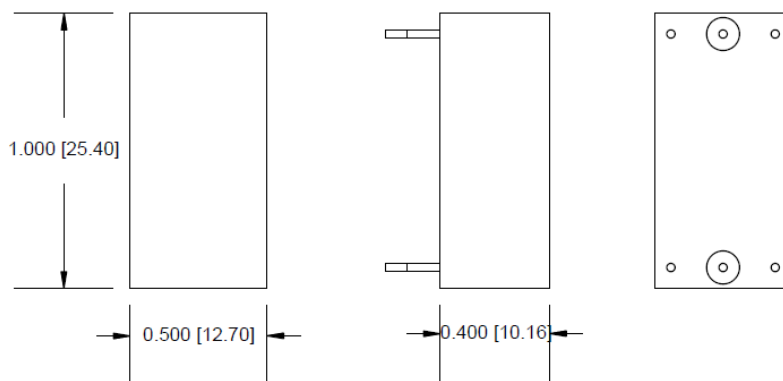

## Electrical Response

